

Telephone Line Surge and Lightning Protector

Select a Telephone Surge Protector when...

...you want to protect your telephone modems from voltage surges and lightning strikes.

- Advanced 3 stage hybrid protection
- Save money on repair and replacement
- Modular and compact design
- DIN rail or direct panel mounting
- Protective grounding to DIN rail
- UL and CE rated for industrial use
- Compatible with SIXNET's Industrial Telephone Modems. Details at: www.industrialmodem.com



Use to protect internal or external modems, or any 2-wire telephone line device.

Surge Protectors Save Equipment and Money

Telephone lines are one of the most common entry points for voltage surges from lightning strikes or other sources. These surges can easily damage or completely destroy your expensive communications equipment. The solution is simple – install an inexpensive surge suppressor on each telephone device.

Performance Specifications

Technology	Solid state sidactors with fast acting fuses and resistors
Usage	Telephone lines
Ports protected	1 (2 lines per port)
Connectors	RJ11 (pins 3, 4)
Surge capacity	1.9 kA / line
Clamp and rated	270 V and 200 V
Max. frequency	50 MHz
Operating temp.	-40 to +85 °C
Max. inline resistance	22 Ohm
Ratings	UL 497A, IEC801-5, CCITT K17

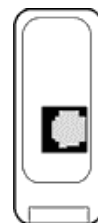
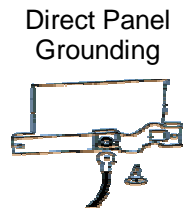
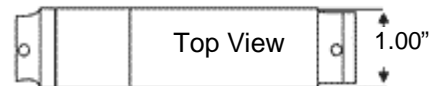
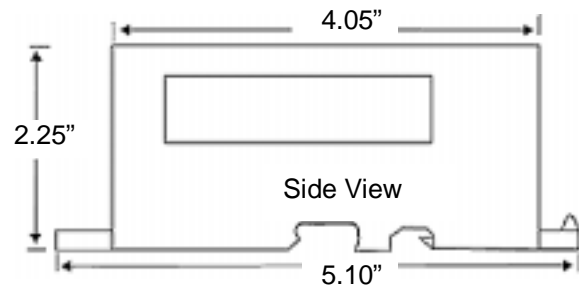

Units are installed inline and identified with "protected" and "unprotected" to provide failsafe installations.

Ordering Information

DESCRIPTION	PART NUMBER	PRICE
Phone line protector (1 piece)	SP-TELCO-1	\$55
Phone line protector (5 pack)	SP-TELCO-1-5	\$225

Notes: Each protector supplied with a grounding kit for direct panel mounting and one telephone patch cable.

Installation Instructions

1. Snap to DIN rail or screw to panel. Make sure DIN rail is grounded. Use grounding kit if direct panel mounting.
2. Correct grounding is essential. Minimize distance from protector to ground point which should be common with AC GND.
3. Connect "unprotected" port to incoming line. Use supplied cable to connect "protected" port to device to be protected.
4. Important notes: Always use supplied patch cable. Ground leads should be 14AWG or larger and less than 12".